

AXO PE METAL / PLASTIC

RACCORDO PER TUBI PE CON ANELLO STRINGITUBO IN OTTONE O **TECNOPOLIMERO**
FITTING FOR PE-PIPE EQUIPPED WITH BRASS OR **TECHNOPOLYMER** PIPE GRIP CONE

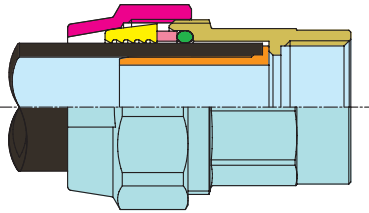

SPECIFICA MATERIALI MATERIAL SPECIFICATION



GUARDA IL VIDEO / WATCH THE VIDEO



PARTICOLARI COMPONENT

- **GHIERA**
RING NUT
 - **CONO STRINGITUBO**

PIPE GRIP CONE
 - **PREMI O-RING**
THRUST RING
 - **O-RING**
 - **BUSSOLA DI RINFORZO***
INTERNAL SUPPORT BUSH*
 - **CORPO**
BODY
- * OPZIONALE (su richiesta)
* OPTIONAL (on request)

MATERIALI MATERIAL

- CW 617 N UNI EN 12165
- CW 614 N UNI EN 12164 (METAL)
TECNOPOLIMERO (PLASTIC)
Technopolymer (Plastic)
- TECNOPOLIMERO
Technopolymer
- ELASTOMERO
Elastomer
- CW 614 N UNI EN 12164
- CW 617 N UNI EN 12165

AXO PE

Il cono stringitubo ed il distanziale premi O-Ring sono in ottone CW 614 N UNI EN 12164 oppure in TECNOPOLIMERO.

DOPPIA TENUTA

La tenuta del fluido ed il bloccaggio del tubo sono ottenuti da due diversi elementi. La tenuta avviene attraverso un **O-Ring** compresso dall'apposito anello. Il bloccaggio del tubo si ottiene attraverso il cono stringitubo avente griffe che si aggrappano mediante il serraggio della ghiera.

FILETTATURE

Estremità filettate ISO 228/1.

PRESSIONE DI ESERCIZIO

PN 16.

IMPIEGHI

I raccordi sono adatti per la giunzione dei seguenti tipi di tubo di polietilene: Polietilene tipo 312 alta densità UNI 7611-7615 (PN 2,5 - PN 4 - PN 6 - PN 10 - PN 16). Polietilene tipo 316 alta densità UNI ISO 4437. Polietilene tipo 312 bassa densità UNI 7990-7991 (PN 4 - PN 6 - PN 10). Il raccordo **AXO PE** è idoneo per uso con acqua, gas inerti ed aeriformi.

NOTA IMPORTANTE

Il prodotto non è utilizzabile per uso con gas combustibili nella distribuzione domestica ai sensi delle prescrizioni della norma UNI-CIG 7129.

LIMITI DI TEMPERATURA

Da -20°C a +90°C.

AXO PE

The pipe grip cone and the thrust ring are in CW 614 N UNI EN 12164 brass or TECNOPOLYMER.

DOUBLE SEAL

The seal of the fitting and the tightness of the pipe are obtained by means of two different elements. The seal is guaranteed by a tapered gasket in elastomer. The tightness of the pipe is instead assured by the pipe grip cone, whose jaws grip the pipe when the ring nut is screwed tight.

END CONNECTIONS

Ends are ISO 228/1 threaded.

PRESSURE LIMITS

PN 16.

APPLICATIONS

The fittings are suitable for connecting the following types of polyethylene pipes: Polyethylene type 312 high density UNI 7611-7615 (PN 2,5 - PN 4 - PN 6 - PN 10 - PN 16). Polyethylene type 316 high density UNI ISO 4437. Polyethylene type 312 low density UNI 7990-7991 (PN 4 - PN 6 - PN 10).

AXO PE fitting is recommended for use with water, air and inert gas.

IMPORTANT NOTE

AXO PE fitting shall not be used for use with domestic fuel gas applications according to the standard UNI-CIG 7129 in Italy or others valid in your country.

TEMPERATURE LIMITS

From -20°C to +90°C

Diagramma pressione/temperatura (prova eseguita con acqua)
Pressure/temperature diagram (tested with water)

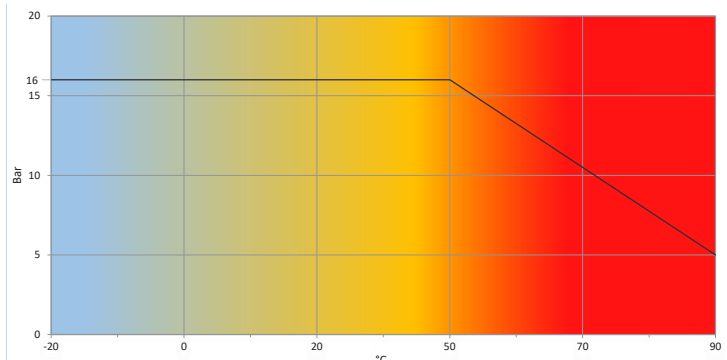

AXO PE PLASTIC

RACCORDO PER TUBI PE CON ANELLO STRINGITUBO
IN OTTONE O **TECNOPOLIMERO**
FITTING FOR PE-PIPE EQUIPPED WITH
BRASS OR **TECHNOPOLYMER** PIPE GRIP CONE

C0300 AXO PE PLASTIC



ERC

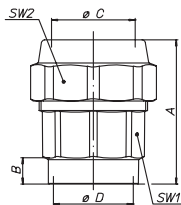

CODICE CODE	MISURA SIZE	Ø TUBO TUBE	PN Bar	A	B	øC	øD	SW1-2	Box Crt
C0300S68	1/2"	20 mm	16	44	9,7	20	1/2"	25-34	40/160
C0300S71	3/4"	25 mm	16	51,8	11,2	25	3/4"	31-40	25/100
C0300S75	1"	32 mm	16	59	12,7	32	1"	38-50	15/60
C0300S78	1 1/4"	40 mm	16	66,5	13,7	40	1 1/4"	47-59	10/40
C0300S81	1 1/2"	50 mm	16	76,5	15,7	50	1 1/2"	57-72	6/24
C0300S84	2"	63 mm	16	89	17,7	63	2"	70-86	4/16
C0300S69 ♦ ❄	1/2"	25 mm	16	50,3	9,7	25	1/2"	31-40	25/100
C0300S72 ♦ ❄	3/4"	32 mm	16	57,2	11,2	32	3/4"	38-50	15/30

- ♦ Tempi di consegna da concordare
Delivery time to be agreed
- ❄ Misure ridotte - Reduced sizes

Raccordo diritto femmina per tubi in polietilene, sabbiato.
Straight fitting for PE-pipe, female, sandblasted.

C0302 AXO PE PLASTIC



ERC

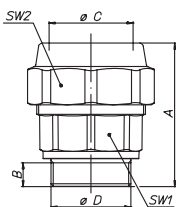

CODICE CODE	MISURA SIZE	Ø TUBO TUBE	PN Bar	A	B	øC	øD	SW1-2	Box Crt
C0302S68	1/2"	20 mm	16	44	8,7	20	1/2"	25-34	40/160
C0302S71	3/4"	25 mm	16	51,3	10,2	25	3/4"	31-40	25/100
C0302S75	1"	32 mm	16	58,5	11,7	32	1"	38-50	15/60
C0302S78	1 1/4"	40 mm	16	65,5	12,7	40	1 1/4"	47-59	10/40
C0302S81	1 1/2"	50 mm	16	75,5	14,2	50	1 1/2"	57-72	6/24
C0302S84	2"	63 mm	16	87,5	16,2	63	2"	70-86	4/16
C0302S69 ♦ ❄	1/2"	25 mm	16	49,8	8,7	25	1/2"	31-40	25/100
C0302S72 ♦ ❄	3/4"	32 mm	16	56,7	10,2	32	3/4"	38-50	15/30

- ♦ Tempi di consegna da concordare
Delivery time to be agreed
- ❄ Misure ridotte - Reduced sizes

Raccordo diritto maschio per tubi in polietilene, sabbiato.
Straight fitting for PE-pipe, male, sandblasted.

C0304 AXO PE PLASTIC

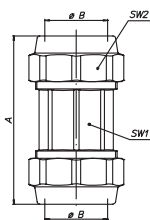

CODICE CODE	Ø TUBO TUBE	PN Bar	A	øB	SW1-2	Box Crt
C0304S18	20 mm	16	64,5	20	25-34	20/100
C0304S21	25 mm	16	75,5	25	31-40	15/60
C0304S25	32 mm	16	85,5	32	38-50	12/48
C0304S28	40 mm	16	96,5	40	47-59	7/14
C0304S31	50 mm	16	113	50	57-72	4/16
C0304S34	63 mm	16	133	63	70-86	2/8

Raccordo diritto bigiunto di accoppiamento per tubi in polietilene, sabbiato.
Straight double fitting for PE-pipe, sandblasted.

C0306 AXO PE PLASTIC



ERC

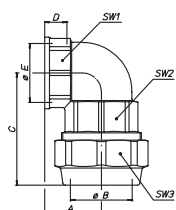

CODICE CODE	MISURA SIZE	Ø TUBO TUBE	PN Bar	A	øB	C	D	øE	SW1-2-3	Box Crt
C0306S68	1/2"	20 mm	16	23,5	20	43	9,7	1/2"	25-25-34	30/150
C0306S71	3/4"	25 mm	16	29,5	25	52	11,2	3/4"	31-31-40	20/80
C0306S75	1"	32 mm	16	34,5	32	60	12,7	1"	38-38-50	10/40
C0306S78	1 1/4"	40 mm	16	39	40	70,5	13,7	1 1/4"	47-47-59	8/16
C0306S81	1 1/2"	50 mm	16	46	50	83,5	15,7	1 1/2"	57-57-72	3/12
C0306S84	2"	63 mm	16	55	63	100,5	17,7	2"	70-70-86	2/8

Raccordo a squadra femmina per tubi in polietilene, sabbiato.
Angle fitting for PE-pipe, female, sandblasted.

AXO PE PLASTIC

RACCORDO PER TUBI PE CON ANELLO STRINGITUBO
IN OTTONE O **TECNOPOLIMERO**
FITTING FOR PE-PIPE EQUIPPED WITH
BRASS OR **TECHNOPOLYMER** PIPE GRIP CONE

C0308 AXO PE PLASTIC



ERC

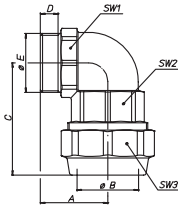

CODICE CODE	MISURA SIZE	Ø TUBO TUBE	PN Bar	A	øB	C	D	øE	SW1-2-3	Box Crt
C0308S68	½"	20 mm	16	28	20	43	8,7	½"	25-25-34	30/150
C0308S71	¾"	25 mm	16	33	25	52	10,2	¾"	31-31-40	20/80
C0308S75	1"	32 mm	16	40	32	60	11,7	1"	38-38-50	10/40
C0308S78	1"¼	40 mm	16	47	40	70,5	12,7	1"¼	47-47-59	8/16
C0308S81	1"½	50 mm	16	54	50	83,5	14,2	1"½	57-57-72	3/12
C0308S84	2"	63 mm	16	64,5	63	100,5	16,2	2"	70-70-86	2/8

Raccordo a squadra maschio per tubi in polietilene, sabbiato.
Angle fitting for PE-pipe, male, sandblasted.

C0310 AXO PE PLASTIC



ERC

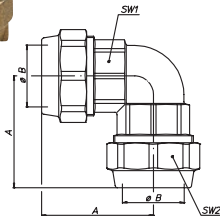

CODICE CODE	Ø TUBO TUBE	PN Bar	A	øB	SW1-2	Box Crt
C0310S18	20 mm	16	43	20	25-34	20/100
C0310S21	25 mm	16	52	25	31-40	12/48
C0310S25	32 mm	16	60	32	38-50	6/24
C0310S28	40 mm	16	70,5	40	47-59	5/10
C0310S31	50 mm	16	83,5	50	57-72	2/8
C0310S34	63 mm	16	100,5	63	70-86	1/8

Raccordo a squadra bigiunto di accoppiamento per tubi in polietilene, sabbiato.
Angle double fitting for PE-pipe, sandblasted.

C0312 AXO PE PLASTIC



ERC

H0312 = H0342

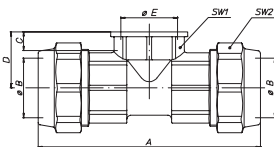

CODICE CODE	MISURA SIZE	Ø TUBO TUBE	PN Bar	A	øB	C	D	øE	SW1-2	Box Crt
C0312S68	½"	20 mm	16	80,5	20	9,7	23,5	½"	34-25	20/80
C0312S71	¾"	25 mm	16	96,5	25	11,2	29,5	¾"	40-31	10/40
C0312S75	1"	32 mm	16	112,5	32	12,7	34,5	1"	50-58	8/16
C0312S78	1"¼	40 mm	16	131	40	13,7	39	1"¼	59-47	4/16
C0312S81	1"½	50 mm	16	156	50	15,7	46	1"½	72-57	2/8
C0312S84	2"	63 mm	16	187	63	17,7	55	2"	86-70	1/8

Raccordo a "T" femmina per tubi in polietilene, sabbiato.
T-fitting for PE-pipe, female, sandblasted.

C0316 AXO PE PLASTIC



ERC

H0316 = H0346

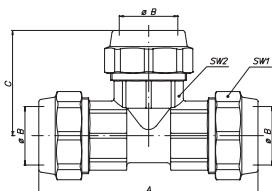

CODICE CODE	Ø TUBO TUBE	PN Bar	A	B	C	SW1-2	Box Crt
C0316S18	20 mm	16	80,5	20	43,5	25-34	12/60
C0316S21	25 mm	16	96,5	25	52	31-40	10/20
C0316S25	32 mm	16	112,5	32	60	38-50	4/20
C0316S28	40 mm	16	131	40	70,5	47-59	4/8
C0316S31	50 mm	16	156	50	83,5	57-72	1/13
C0316S34	63 mm	16	187	63	100,5	70-86	1/6

Raccordo a "T" di accoppiamento per tubi in polietilene, sabbiato.
T-fitting for PE-pipe, sandblasted.

AXO PE METAL

RACCORDO PER TUBI PE CON ANELLO STRINGITUBO
IN OTTONE O **TECNOPOLIMERO**
FITTING FOR PE-PIPE EQUIPPED WITH
BRASS OR **TECHNOPOLYMER** PIPE GRIP CONE

H0330 AXO PE METAL



ERC

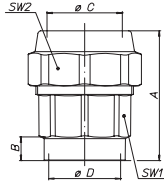

CODICE CODE	MISURA SIZE	Ø TUBO TUBE	PN Bar	A	B	øC	øD	SW1-2	Box Crt
H0330S68	1/2"	20 mm	16	44	9,7	20	1/2"	25-34	40/160
H0330S71	3/4"	25 mm	16	51,8	11,2	25	3/4"	31-40	25/100
H0330S75	1"	32 mm	16	59	12,7	32	1"	38-50	15/60
H0330S78	1 1/4"	40 mm	16	66,5	13,7	40	1 1/4"	47-59	10/40
H0330S81	1 1/2"	50 mm	16	76,5	15,7	50	1 1/2"	57-72	6/24
H0330S84	2"	63 mm	16	89	17,7	63	2"	70-86	4/16

Raccordo diritto femmina per tubi in polietilene, con componenti interni in ottone, sabbiato.
Straight fitting for PE-pipe, female, with inner components in brass, sandblasted.

H0332 AXO PE METAL



ERC

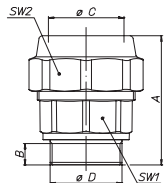

CODICE CODE	MISURA SIZE	Ø TUBO TUBE	PN Bar	A	B	øC	øD	SW1-2	Box Crt
H0332S68	1/2"	20 mm	16	44	8,7	20	1/2"	25-34	40/160
H0332S71	3/4"	25 mm	16	51,3	10,2	25	3/4"	31-40	25/100
H0332S75	1"	32 mm	16	58,5	11,7	32	1"	38-50	15/60
H0332S78	1 1/4"	40 mm	16	65,5	12,7	40	1 1/4"	47-59	10/40
H0332S81	1 1/2"	50 mm	16	75,5	14,2	50	1 1/2"	57-72	6/24
H0332S84	2"	63 mm	16	87,5	16,2	63	2"	70-86	4/16

Raccordo diritto maschio per tubi in polietilene, con componenti interni in ottone, sabbiato.
Straight fitting for PE-pipe, male, with inner components in brass, sandblasted.

H0334 AXO PE METAL



ERC

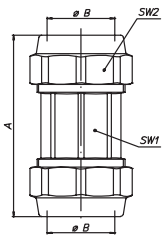

CODICE CODE	Ø TUBO TUBE	PN Bar	A	øB	SW1-2	Box Crt
H0334S18	20 mm	16	64,5	20	25-34	20/100
H0334S21	25 mm	16	75,5	25	31-40	15/60
H0334S25	32 mm	16	85,5	32	38-50	12/48
H0334S28	40 mm	16	96,5	40	47-59	7/14
H0334S31	50 mm	16	113	50	57-72	4/16
H0334S34	63 mm	16	133	63	70-86	2/8

Raccordo diritto bigiunto di accoppiamento per tubi in polietilene, con componenti interni in ottone, sabbiato.
Straight double fitting for PE-pipe, with inner components in brass, sandblasted.

H0336 AXO PE METAL



ERC

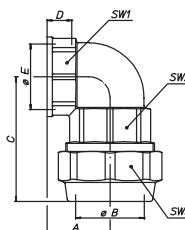

CODICE CODE	MISURA SIZE	Ø TUBO TUBE	PN Bar	A	øB	C	D	øE	SW1-2-3	Box Crt
H0336S68	1/2"	20 mm	16	23,5	20	43	9,7	1/2"	25-25-34	30/150
H0336S71	3/4"	25 mm	16	29,5	25	52	11,2	3/4"	31-31-40	20/80
H0336S75	1"	32 mm	16	34,5	32	60	12,7	1"	38-38-50	10/40
H0336S78	1 1/4"	40 mm	16	39	40	70,5	13,7	1 1/4"	47-47-59	8/16
H0336S81	1 1/2"	50 mm	16	46	50	83,5	15,7	1 1/2"	57-57-72	3/12
H0336S84	2"	63 mm	16	55	63	100,5	17,7	2"	70-70-86	2/8

Raccordo a squadra femmina per tubi in polietilene, con componenti interni in ottone, sabbiato.
Angle fitting for PE-pipe, female, with inner components in brass, sandblasted.

AXO PE METAL

RACCORDO PER TUBI PE CON ANELLO STRINGITUBO
IN OTTONE O **TECNOPOLIMERO**
FITTING FOR PE-PIPE EQUIPPED WITH
BRASS OR **TECHNOPOLYMER** PIPE GRIP CONE

H0338 AXO PE METAL



ERC

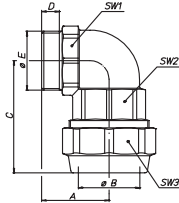

CODICE CODE	MISURA SIZE	Ø TUBO TUBE	PN Bar	A	øB	C	D	øE	SW1-2-3	Box Crt
H0338S68	1/2"	20 mm	16	28	20	43	8,7	1/2"	25-25-34	30/120
H0338S71	3/4"	25 mm	16	33	25	52	10,2	3/4"	31-31-40	20/80
H0338S75	1"	32 mm	16	40	32	60	11,7	1"	38-38-50	10/40
H0338S78	1 1/4"	40 mm	16	47	40	70,5	12,7	1 1/4"	47-47-59	8/16
H0338S81	1 1/2"	50 mm	16	54	50	83,5	14,2	1 1/2"	57-57-72	3/12
H0338S84	2"	63 mm	16	64,5	63	100,5	16,2	2"	70-70-80	2/8

Raccordo a squadra maschio per tubi in polietilene, con componenti interni in ottone, sabbiato.
Angle fitting for PE-pipe, male, with inner components in brass, sandblasted.

H0340 AXO PE METAL



ERC

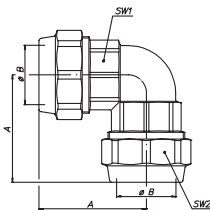

CODICE CODE	Ø TUBO TUBE	PN Bar	A	øB	SW1-2	Box Crt
H0340S18	20 mm	16	43	20	25-34	20/100
H0340S21	25 mm	16	52	25	31-40	12/48
H0340S25	32 mm	16	60	32	38-50	6/24
H0340S28	40 mm	16	70,5	40	47-59	5/10
H0340S31	50 mm	16	83,5	50	57-72	2/8
H0340S34	63 mm	16	100,5	63	70-86	1/5

Raccordo a squadra bigiunto di accoppiamento per tubi in polietilene, con componenti interni in ottone, sabbiato.
Angle double fitting for PE-pipe, with inner components in brass, sandblasted.

H0342 AXO PE METAL



ERC

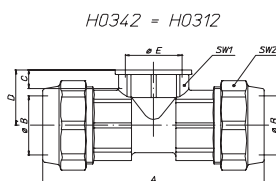

CODICE CODE	MISURA SIZE	Ø TUBO TUBE	PN Bar	A	øB	C	D	øE	SW1-2	Box Crt
H0342S68	1/2"	20 mm	16	80,5	20	9,7	23,5	1/2"	34-25	20/80
H0342S71	3/4"	25 mm	16	96,5	25	11,2	29,5	3/4"	40-31	10/40
H0342S75	1"	32 mm	16	112,5	32	12,7	34,5	1"	50-58	8/16
H0342S78	1 1/4"	40 mm	16	131	40	13,7	39	1 1/4"	59-47	4/16
H0342S81	1 1/2"	50 mm	16	156	50	15,7	46	1 1/2"	72-57	2/8
H0342S84	2"	63 mm	16	187	63	17,7	55	2"	86-70	1/1

Raccordo a "T" femmina per tubi in polietilene, con componenti interni in ottone, sabbiato.
T-fitting for PE-pipe, female, with inner components in brass, sandblasted.

H0346 AXO PE METAL



ERC

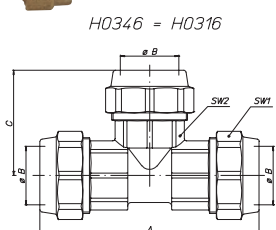

CODICE CODE	Ø TUBO TUBE	PN Bar	A	B	C	SW1-2	Box Crt
H0346S18	20 mm	16	80,5	20	43,5	25-34	12/48
H0346S21	25 mm	16	96,5	25	52	31-40	10/20
H0346S25	32 mm	16	112,5	32	60	38-50	4/20
H0346S28	40 mm	16	131	40	70,5	47-59	4/8
H0346S31	50 mm	16	156	50	83,5	57-72	1/8
H0346S34	63 mm	16	187	63	100,5	70-86	1/5

Raccordo a "T" di accoppiamento per tubi in polietilene, con componenti interni in ottone, sabbiato.
T-fitting for PE-pipe, with inner components in brass, sandblasted.

AXO PE METAL

RACCORDO PER TUBI PE CON ANELLO STRINGITUBO
IN OTTONE O **TECNOPOLIMERO**
FITTING FOR PE-PIPE EQUIPPED WITH
BRASS OR **TECHNOPOLYMER** PIPE GRIP CONE

H0915 AXO PE

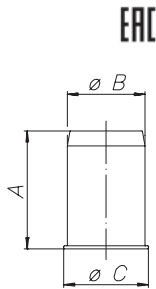

CODICE CODE	Ø TUBO TUBE	PN Bar	A	ØB	ØC	Pcs. Box/ Crt
H0915L18	20 mm	-	29	13,7	15	50/750
H0915L21	25 mm	-	35	18,7	20	50/250
H0915L25	32 mm	-	39	25,7	28	30/150
H0915L28	40 mm	-	45	32,2	34	15/75
H0915L31	50 mm	-	53	40,4	42	20/80
H0915L34	63 mm	-	67	51	59,5	5/25
H0915L36	75 mm	-	80	60,8	65	6/24
H0915L38	90 mm	-	90	73,2	78	4/16

Boccola di rinforzo.
Internal Support Bush.

