

BON GAS PORTAGOMMA

RUBINETTO A SFERA CON PORTAGOMMA
BALL VALVE WITH CONNECTOR

ENOLGAS
Ispirati dal passato, proiettati nel futuro.



SPECIFICA MATERIALI MATERIAL SPECIFICATION

PARTICOLARI COMPONENT

MATERIALI MATERIAL

DESCRIZIONE DESCRIPTION

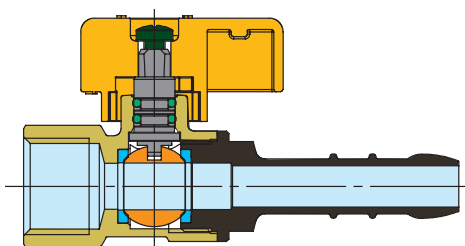

■ CORPO BODY	CW 617 N UNI EN 12165	STAMPATO DA BARRA, NICHELATO Forged, Nickel-Plated
■ MANICOTTO END ADAPTER	CW 617 N UNI EN 12165	STAMPATO DA BARRA, NICHELATO Forged, Nickel-Plated
■ SFERA BALL	CW 614 N UNI EN 12164	DA BARRA, NICHEL-CROMATA Machined, Chrome-Plated
■ SEDI LATERALI BALL GASKETS	PTFE	VERGINE Virgin
■ PERNO STEM	CW 614 N UNI EN 12164	DA BARRA Machined
■ ANELLO ANTIFRIZIONE THRUST WASHER	PTFE	VERGINE Virgin
■ O-RINGS	ELASTOMERO Elastomer	ADATTO ALL'USO PER GAS A NORMA EN549 Suitable For Use With Gas En549
■ LEVA LEVER HANDLE	ACCIAIO ZINCATO Zinc-Plated Steel	PLASTIFICATA IN PVC Pvc Insulated
■ VITE SCREW	ACCIAIO Steel	ZINCATA Zinc-Plated

GUARDA IL VIDEO / WATCH THE VIDEO



FILETTATURE Estremità portagomma secondo UNI 7141.
Estremità filettate UNI EN 10226.

IMPIEGHI Gas combustibili: 1° - 2° - 3° famiglia

**PRESSIONE
DI ESERCIZIO** Per gas combustibili MOP5.
Per altri usi PN 40.

**LIMITI
DI TEMPERATURA** Per gas combustibili da -20°C a +60°C.
Per altri usi da -20°C a +90°C.

NOTA BENE Tutti gli articoli con portagomma possono
essere utilizzati con gas combustibili in accordo
alle normative vigenti nei singoli paesi.
Enolgas declina ogni responsabilità per un
utilizzo non corretto di tali articoli.

END CONNECTIONS Hose holder connector to UNI 7141.
Screwed to UNI EN 10226.

APPLICATIONS Fuel gas: 1st - 2nd -3rd family

**PRESSURE
LIMITS** For fuel gas MOP5.
For other uses PN 40.

**TEMPERATURE
LIMITS** For fuel gas from -20°C to +60°C.
For other uses from -20°C to + 90°C.

REMARK All the items with hose connector can be used
for fuel gas in accordance with the standard
valid in each single country. Enolgas declines
any responsibility in case of any improper use.

Diagramma pressione/temperatura (prova eseguita con acqua)
Pressione/temperature diagram (tested with water)

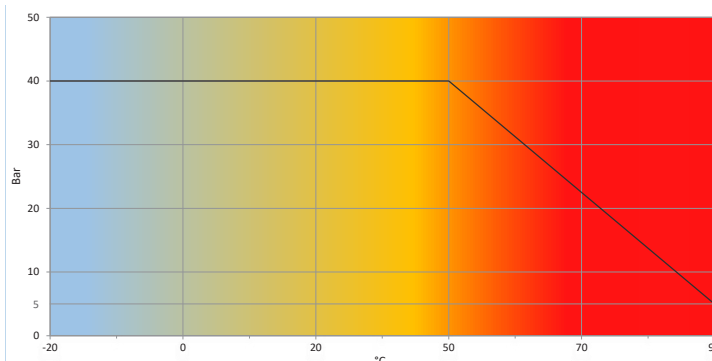

BON GAS PORTAGOMMA

RUBINETTO A SFERA
CON PORTAGOMMA
BALL VALVE WITH CONNECTOR

G0300 BON GAS



ERC

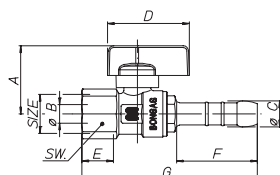

CODICE CODE	MISURA SIZE	RESCA BARS	PN Bar	A	øB	øC	D	E	F	G	SW	Box Crt
G0300N34	½" (DN 15)	14 mm	40	36,5	10	14	44	15	44,5	94,5	25	20/160

Rubinetto a sfera per gas combustibili femmina con portagomma secondo UNI7141, con levetta in alluminio plastificata gialla, nichelato.
Ball cock for fuel gas, female/hose connector according UNI7141, with yellow plastic coated aluminium lever, nickel-plated.

G0302 BON GAS



ERC

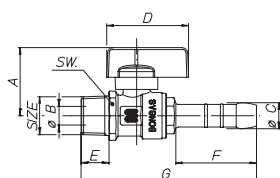

CODICE CODE	MISURA SIZE	RESCA BARS	PN Bar	A	øB	øC	D	E	F	G	SW	Box Crt
G0302N03	¾" (DN10)	14 mm	40	36,6	10	14	44	11,9	44,5	91,5	21	25/100
G0302N04	½" (DN 15)	14 mm	40	36,6	10	14	44	15	44,5	94,5	25	20/100

Rubinetto a sfera per gas combustibili maschio con portagomma secondo UNI7141, con levetta in alluminio plastificata gialla, nichelato.
Ball cock for fuel gas, male/hose connector according UNI7141, with yellow plastic coated aluminium lever, nickel-plated.

G0308 BON GAS



ERC

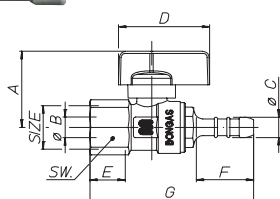

CODICE CODE	MISURA SIZE	RESCA BARS	PN Bar	A	øB	øC	D	E	F	G	SW	Box Crt
G0308N33	¾" (DN10)	10 mm	40	36,5	10	9,8	44	11,4	29	74	21	25/125
G0308N34	½" (DN 15)	10 mm	40	36,5	10	9,8	44	15	29	79	25	20/100

Rubinetto a sfera per gas combustibili femmina con portagomma secondo UNI7141, con levetta in alluminio plastificata gialla, nichelato.
Ball cock for L.P.G., female/hose connector according UNI7141, with yellow plastic coated aluminium lever, nickel-plated.

G0310 BON GAS



ERC

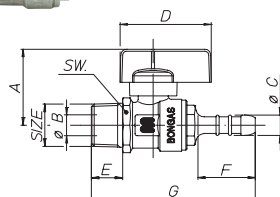

CODICE CODE	MISURA SIZE	RESCA BARS	PN Bar	A	øB	øC	D	E	F	G	SW	Box Crt
G0310N02	¼" (DN8)	10 mm	40	36,6	8,5	9,8	44	11,5	29	76	21	25/125
G0310N03	¾" (DN10)	10 mm	40	36,6	10	9,8	44	11,9	29	76	21	20/125
G0310N04	½" (DN 15)	10 mm	40	36,6	10	9,8	44	15	29	79	25	20/100

Rubinetto a sfera per gas combustibili maschio con portagomma secondo UNI7141, con levetta in alluminio plastificata gialla, nichelato.
Ball cock for L.P.G., male/hose connector according UNI7141, with yellow plastic coated aluminium lever, nickel-plated.

BON GAS PORTAGOMMA

RUBINETTO A SFERA
CON PORTAGOMMA
BALL VALVE WITH CONNECTOR

G0314 BON GAS

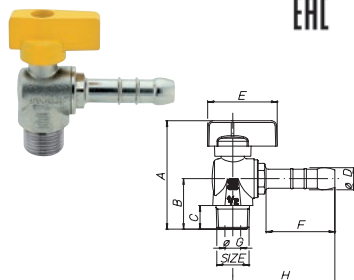

CODICE CODE	MISURA SIZE	RESCA BARS	PN Bar	A	B	C	øD	E	F	øG	H	Box Crt
G0314N03	3/8" (DN10)	14 mm	40	65,1	28,5	11,9	14	44	44,5	10	64,7	25/100
G0314N04	1/2" (DN 15)	14 mm	40	68,5	32	15	14	44	44,5	10	64,7	20/80

Rubinetto a sfera per gas combustibili maschio con portagomma secondo UNI7141,
con levetta in alluminio plastificata gialla, nichelato.
Angle ball cock for fuel gas, male/hose connector according UNI7141,
with yellow plastic coated aluminium lever, nickel-plated.

G0320 BON GAS

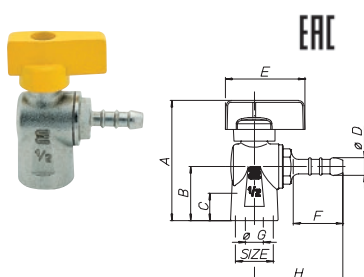

CODICE CODE	MISURA SIZE	RESCA BARS	PN Bar	A	B	C	øD	E	F	øG	H	Box Crt
G0320N33	3/8" (DN10)	10 mm	40	61,5	25	11,4	9,8	44	29	10	49,2	25/125
G0320N34	1/2" (DN 15)	10 mm	40	66,5	30	15	9,8	44	29	10	49,2	20/100

Rubinetto a sfera per gas combustibili a squadra femmina con portagomma secondo UNI7141,
con levetta in alluminio plastificata gialla, nichelato.
Angle ball cock for L.P.G., male/hose connector according UNI7141,
with yellow plastic coated aluminium lever, nickel-plated.

G0322 BON GAS

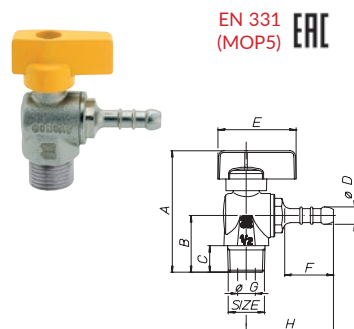

CODICE CODE	MISURA SIZE	RESCA BARS	PN Bar	A	B	C	øD	E	F	øG	H	Box Crt
G0322N03	3/8" (DN10)	10 mm	40	65,1	28,5	11,9	9,8	44	29	10	49,2	25/125
G0322N04	1/2" (DN 15)	10 mm	40	68,6	32	15	9,8	44	29	10	49,2	20/100

Rubinetto a sfera per gas combustibili a squadra maschio con portagomma secondo UNI7141,
con levetta in alluminio plastificata gialla, nichelato.
Angle ball cock for L.P.G., male/hose connector according UNI7141,
with yellow plastic coated aluminium lever, nickel-plated.

